

INSTALLATION INSTRUCTIONS

AIRCRAFT® RECESSED-MOUNTED AUTOMATIC HAND/HAIR DRYER



Electrical Characteristics

Hand dryer models B-750, B-7507, and Hair dryer model B-781, 115V AC, 20 Amp, 50/60 Hz, Single Phase, UL/c-UL listed.

Hand dryer models B-750, B-7507, and Hair dryer model B-781, 208–240V AC, 9–10 Amp, 50/60 Hz, Single Phase; UL/c-UL listed, VDE approved and CE marked.

Recommended Mounting Heights

Distance from floor to bottom of framed wall opening. (Dimension A)

Hand Dryer	Hair Dryer
Men's Washrooms 46" (117cm)	Men's Dressing Rooms 73" (186cm)
Women's Washrooms 43" (109cm)	Women's Dressing Rooms 64" (163cm)
Children's Washrooms, ages 3-9 31" (79cm)	Children's Dressing Rooms, ages 3-9 46" (117cm)
Children's Washrooms, ages 9-12 35" (89cm)	Children's Dressing Rooms, ages 9-12 53" (135cm)
Children's Washrooms, ages 12-15 39" (99cm)	Children's Dressing Rooms, ages 12-15 59" (150cm)
Children's Washrooms, ages 15-18 43" (109cm)	Children's Dressing Rooms, ages 15-18 64" (163cm)
For the Handicapped 38" (97cm)	

* Bobrick automatic hand dryers should be installed 15" (380mm) above any projection or horizontal surface which may interfere with the operation of the automatic sensor.

Removal of Cover

1. Start installation of aluminum base unit into recessed mounting box by removing cover. To loosen two cover bolts insert Allen Wrench, provided with dryer, into holes located on bottom of cover on each side of air intake grille. Make sure wrench fits into head of cover bolts and turn **CLOCKWISE** until bolts stop turning. When both cover bolts are screwed in all the way, cover can be removed.

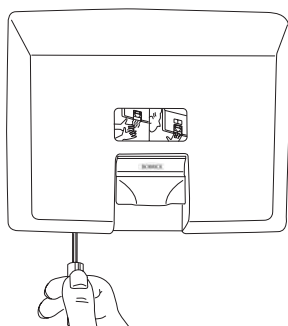

2. To remove cover, place a hand on each side of cover and push up toward top of dryer releasing cover from studs at top of aluminum base unit. Lift cover off mounting base by pulling forward at the bottom and upward at the same time.
3. Insert aluminum base unit into recessed mounting box and fasten to top and bottom flanges of mounting box with the four 1/4-20 UNC (MG-1) screws provided.

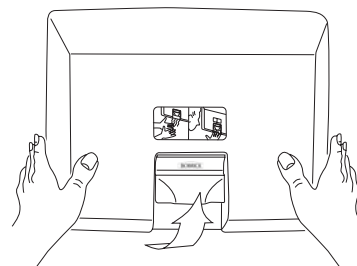

Installation of Aluminum Base Limit Into Recessed Mounting Box

1. Provide framed opening in wall 13-3/4" wide x 9-1/2" high x 3-3/4" deep (349 x 241 x 95mm) at the desired location of the installed dryer. See recommended mounting heights above.
2. Frame the opening as shown in diagram to support recessed mounting box.
3. Place the recessed mounting box in wall and cut an opening in the framing to allow clearance for electrical conduit and fittings at one of the three conduit knockout locations.
4. Fasten recessed mounting box to framing with minimum of four No. 10 (M4.8mm) sheet metal screws (not furnished by Bobrick). Make sure flanges of mounting box are completely flat against finished wall surface. If necessary, use shims or spacers between mounting box and framed wall opening to prevent distortion to box as it is fastened to framing.
5. Install electrical conduit from nearest distribution panel to recessed mounting box. Attach conduit fittings to mounting box. Use wire as required by local electrical code. In the United States and Canada, use No. 12 wire or larger. Allow a minimum of 24" (610mm) of wire to remain in recessed mounting box for connection to dryer terminals.

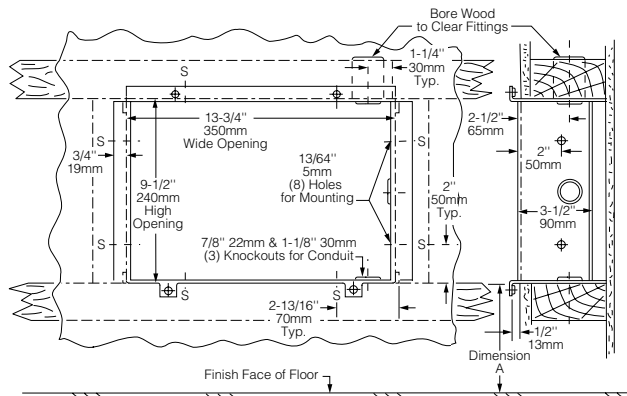

WARNING: TURN ELECTRICAL POWER SUPPLY OFF BEFORE MAKING ELECTRICAL CONNECTIONS. DRYER MUST BE GROUND (EARTHED).

Electrical Connection

FOR PROPER ELECTRICAL CONNECTIONS, CHECK LOCAL BUILDING CODE. UNIT MUST BE INSTALLED BY A QUALIFIED LICENSED ELECTRICIAN

1. Wiring Instructions:
 - a. **For 115 Volt Dryers:** Connect ground (earthed) wire to ground (earthed) terminal marked \perp , the black or *Hot* wire to terminal marked *L1* and neutral or white wire to terminal marked *N*. **A DEDICATED LINE IS REQUIRED FOR EACH 115 VOLT DRYER.**
 - b. **For 208–240 Volt Dryers:** Connect ground (earthed) wire to ground (earthed) terminal marked \perp and the 208-240 Volt wires to terminals marked *L (L1)* and *N (L2)*.
2. Make sure excess wire does not interfere with operation of dryer.

Replace Cover

1. Replace cover by positioning top of cover on studs on top of aluminum base unit and tipping bottom of cover toward aluminum base. Push bottom of cover firmly against base.

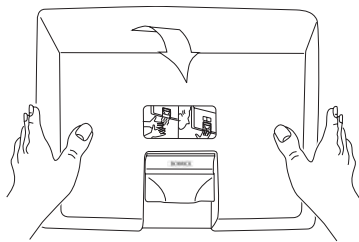

NOTE: Space between cover and base must be the same on bottom and both sides.

2. To tighten two cover bolts, insert Allen wrench into holes on bottom edge of cover. Make sure wrench fits into head of cover bolts and turn COUNTERCLOCKWISE until bolts are tightened.

NOTE: Do not overtighten cover bolts; overtightening cover bolts may damage enamel finish.

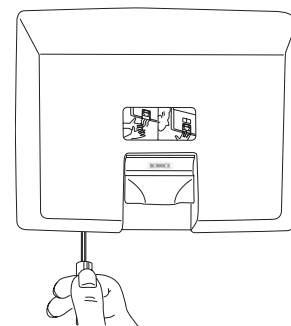

Check Dryer Operation

1. **For TouchButton Hand and Hair Dryers:** Turn electrical power supply on. Touch the chrome-plated touchbutton once and dryer should turn on. Touch the touchbutton again after a few seconds and dryer should stop. If left on, Hand Dryers will shut off automatically after 30 seconds; Hair Dryers will shut off after 80 seconds.
2. **For AutoPilot Hand Dryers:** Turn electrical power supply on. Position hands under nozzle and dryer should turn on. Remove hands from under nozzle and dryer should stop.
3. **For AutoPilot Hair Dryers:** Turn electrical power supply on. Position head under nozzle and dryer should turn on. Remove head from under nozzle and dryer should stop.

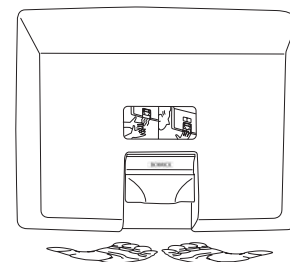

Maintenance

WARNING: MOTOR LAMINATIONS ARE LIVE. TURN ELECTRICAL POWER SUPPLY OFF BEFORE DOING ANY MAINTENANCE OR SERVICE TO DRYER. DRYER MUST NOT BE OPERATED UNLESS COVER IS IN PLACE.

1. Exterior of cover should be cleaned with a damp cloth to remove dust and surface dirt. Do not use abrasive agents or solvents as they may permanently damage surface of cover.
2. At least once every 6 months remove cover. Using a small brush or vacuum, clean out buildup of dust and lint from air-intake grille and baffle.
NOTE: if dryer is installed where there is a lot of dust and dirt in the air, the interior of the dryer should be cleaned out more frequently.

Warranty

IMPORTANT	LIMITED WARRANTY	SAVE
Installation Date: _____		
Serial No(s): _____		
Installation Address: _____		
Telephone No.: _____		
<p>The Bobrick Dryer of the serial number(s) indicated herein, and all parts (except motor brushes) are warranted to the original owner of the installed unit for ten years from date of original purchase for No-Touch and TouchButton hand and hair dryers and five years for Model B-709 hand dryer, against defects in factory workmanship or material under normal use and service. *</p> <p>*Motor brushes shall be warranted for three years from date of purchase. This warranty is limited to repair or exchange of defective parts at the option of Bobrick Washroom Equipment, Inc.</p> <p>THIS WARRANTY DOES NOT COVER ACCIDENTAL DAMAGE, IMPROPER HANDLING OR INSTALLATION, OR REPAIRS MADE BY UNAUTHORIZED PERSONS, AND SPECIFICALLY EXCLUDES CLAIMS FOR INDIRECT, ACCIDENTAL OR CONSEQUENTIAL DAMAGES TO PROPERTY. THE IMPLIED WARRANTIES OF MERCHANTABILITY AND FITNESS FOR A PARTICULAR PURPOSE ARE LIMITED TO THE SAME DURATION OF THE ABOVE WARRANTY.</p> <p>Some states do not allow the exclusion of incidental or consequential damages, so the above limitation or exclusion may not apply to you. Some states do not allow limitations on how long an implied warranty lasts, so the above limitation may not apply to you. This warranty gives you specific legal rights, and you may also have other rights which vary from state to state.</p> <p>* Normal service constitutes performing the following preventive maintenance procedures at six-month intervals.</p> <p>A. Remove cover and clean any lint, dust or grease from air-intake grille and baffle from behind air-outlet nozzle.</p> <p>B. Visually inspect motor brushes to insure remaining brush length is a minimum of 1/2 inch (12.7mm).</p> <p>Labor costs for preventive maintenance shall be at owner's expense.</p> <p>For repair or exchange of defective part, send the part, together with installation date and serial number, to BOBRICK.</p>		